

ACADEMY OF AEROSPACE SCIENCE AND ENGINEERING

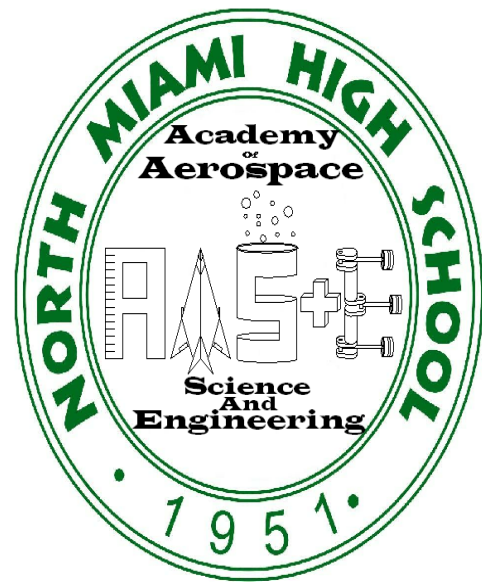

NORTH MIAMI SENIOR HIGH



ENTER AT YOUR OWN RISK



ACADEMY

UNDER



Development

Development

Personalized Learning Environments

- Academically rigorous, curriculum
- Relevant to real-world contexts and that builds upon student and community assets.
- Interactions among and between adults and students defined by trust, respect, open communication

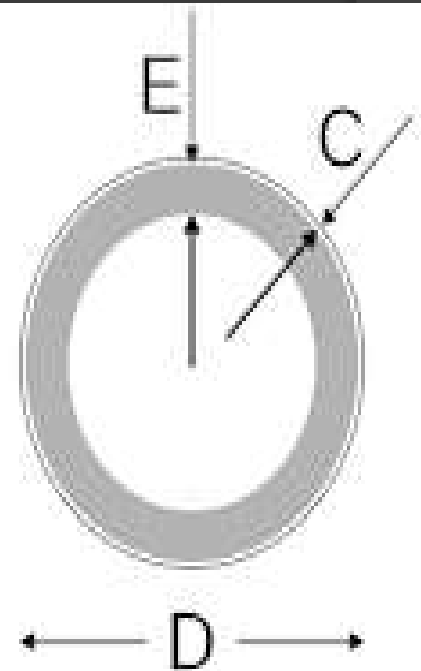



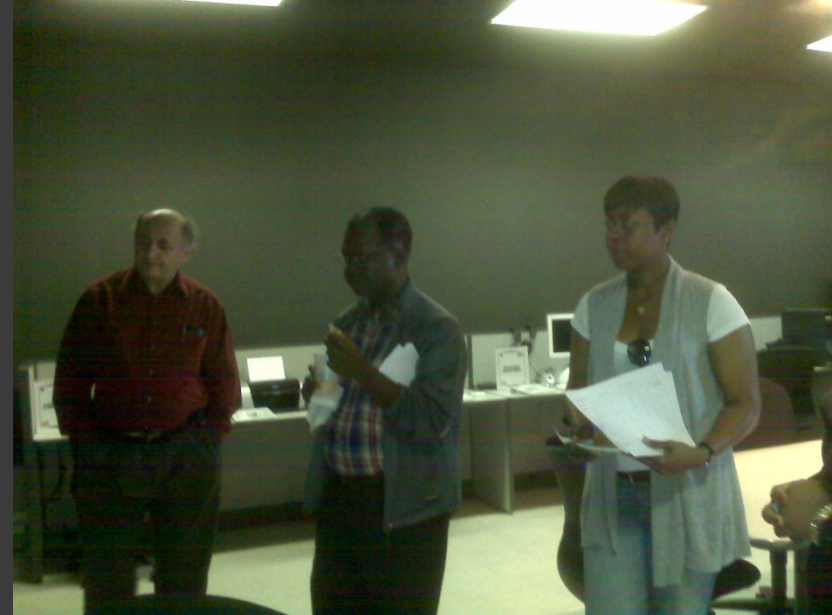

Aerospace Education Laboratory @ FMU



Academic Engagement of All Students

- Academic engagement is also fostered through networks of adults who actively connect students with resources, guidance, and information needed to make decisions about course-taking, post-secondary education, and career pathways.





Reverse Engineering



Building Green

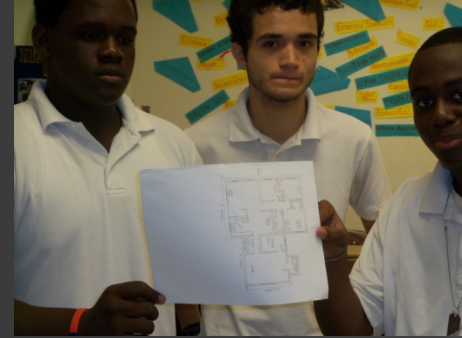

Empowered Educators



- Work collaboratively and continuously seek, share, and act on their learning in order to improve their practice for the purpose of improved student outcomes.

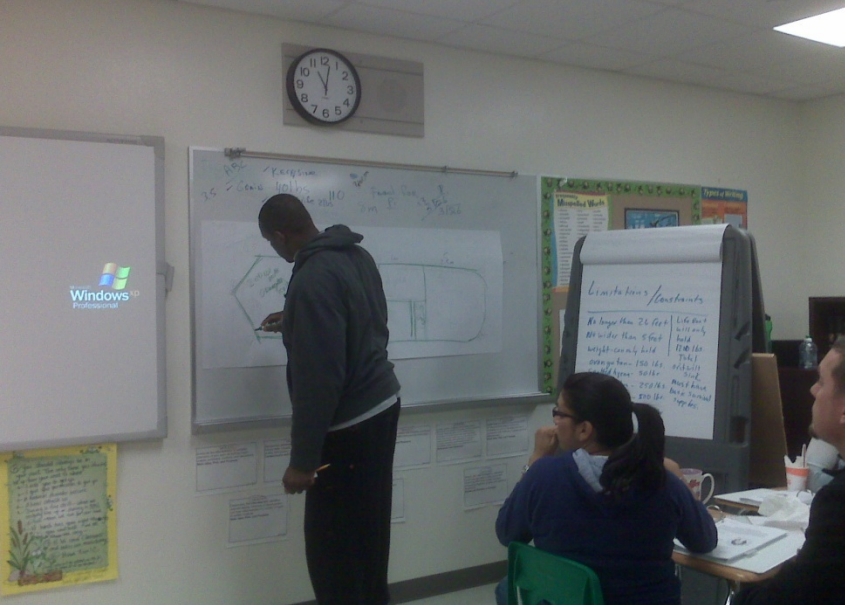

Project-Based Learning

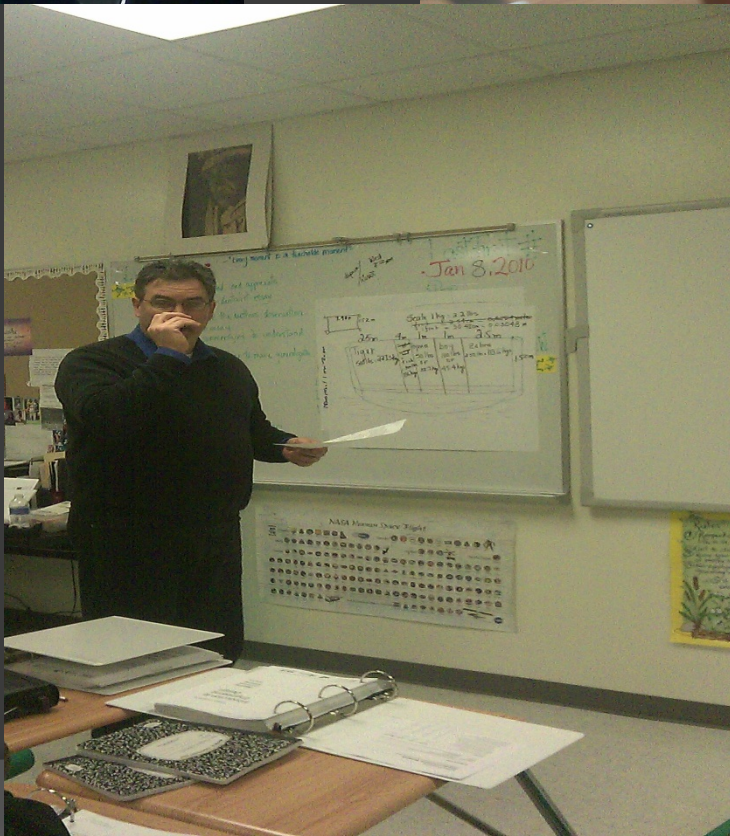



Differentiated Instruction

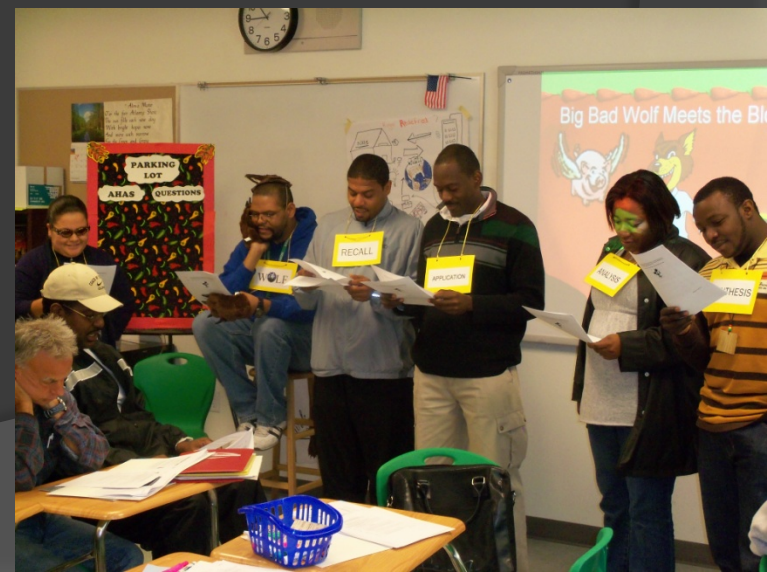
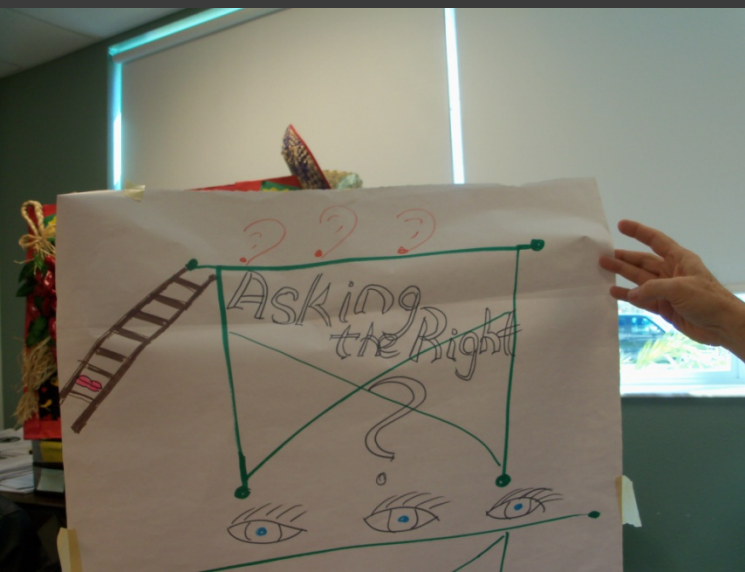

Accountable Leaders

- Leaders at all levels of the education system must be accountable to, and work in partnership with, the communities and youth they serve.

CAUTION

**CONSTRUCTION
AREA AUTHORIZED
PERSONNEL ONLY**



Engaged Community and Youth



- All facets of the community are needed to articulate a shared vision for all high school-age youth and to establish a network of accountability that ensures progress towards achieving that shared vision.

NOMI

KIDS & DEMOCRACY



My City: I'm Part of it and Proud of it.

North Miami Feeder Pattern Schools

"A Region Center II Alignment Initiative"

S.T.E.M.

Mathematics and Science



Academy Night





Student Industry Conference



An Integrated system of high standards, curriculum, instruction, assessments, and supports

- Common expectations for all students.
- Communicates parameters for success
- Outlines how students will learn, be assessed, and receive support.









© Exiting construction zone
Exiting construction zone